

## Contents

- 1 Front Cover
- 2 Safety Instructions
- 3 Operating Instructions
- 4 Back Cover



**6 x Tiki Torches**

## Contents

- 1 Front Cover
- 2 Safety Instructions
- 3 Operating Instructions
- 4 Back Cover

# Safety Instructions

### Notice: Ensure you read and fully understand instructions before use

While every attempt is made to ensure the highest degree of protection in all equipment, we cannot guarantee freedom from injury. The user assumes all risk of injury due to use. All merchandise is sold on this condition, which no representative of the company can waive or change.

- This product is not a toy, and is only to be used for its designated purpose.
- Never carry out any alterations or modifications to this product.
- **Warning:** in the case of small children, just a sip of lamp oil – or even sucking the wick – may lead to life-threatening lung damage. Do not allow children to operate or play with the product. If lamp oil is swallowed, seek medical advice immediately.
- Find a suitable outdoor-only location for the torch. Do not place the torch under a covered shelter, near pedestrian traffic, or combustibles such as wood structures, fuel, clothing, or dry vegetation.
- Do not light in windy conditions. Be cautious of inclement weather.
- This product is intended for outdoor use only.
- Contents and fumes are harmful. Do not swallow. Do not get in eyes or on skin or clothing. Do not breathe fumes.
- Risk of serious injury. Never place face, hair, or clothes near a burning flame.
- Keep out of reach of children and pets.
- Never leave this product unattended.
- Product will become hot while in use.
- Do not tip the torch as fuel can spill and cause fire or serious injury.
- Keep the area around the tiki torch clear of combustibles.
- Keep the tiki torch fuel supply safely stored. The jug or container of tiki torch oil should be stored in a cool, dry, well ventilated location and a distance away from the open flame on the torches.
- The fuel used in the tiki torches is highly flammable. Clean up spills promptly.
- Never move a lit tiki torch. Always extinguish the tiki torch and give it time to cool before moving it.
- Only use fuel made for tiki torches. Never use gasoline, ethylated spirits or other flammable liquids.
- Always allow the torches sufficient time to cool down before moving them.

## Contents

- 1 Front Cover
- 2 Safety Instructions
- 3 Operating Instructions
- 4 Back Cover

# Operating Instructions

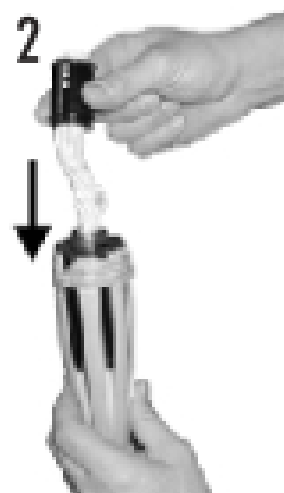

Place the lamp on a stable, flat and heat-resistant surface. Fill the lamp with lamp oil to a maximum of 1.5cm below the edge of the oil reservoir. Make sure that the wick does not stick out of the wick guard. Let the wick soak the fuel for up to 5-7 minutes before lighting. Light the wick using a lighter or a match. Extinguish the flame by covering the flame completely. Make sure the lamp has cooled down completely before storing. The wick length should be between 0.6cm and 1.25cm in order to prevent smoke and soot. Cut the wick at the desired length. Make the wick longer by pulling.

Only use natural lamp or torch oil that does not cause lung damage after swallowing. Check the label on the bottle of the oil. Only use clear colourless torch oil or lamp oil.

To (re)fill the oil reservoir, first push the wick guard in and open the oil reservoir by turning counter-clockwise. Fill to a maximum of 1.5cm below the edge. Close the oil reservoir carefully by pushing the wick guard and turn clockwise to tighten.

To keep the oil lamp in good condition, store it indoors after use. Make sure it does not get wet or damaged due to weather conditions. Clean the oil lamp with a damp cloth and to protect it, make sure the wick and container stay oily.

# Contents

- 1 Front Cover
- 2 Safety Instructions
- 3 Operating Instructions
- 4 Back Cover

## **HAVE A QUESTION ABOUT YOUR PURCHASE?**

OUR DEDICATED CUSTOMER SERVICES TEAM ARE HAPPY TO HELP  
CONTACT THEM VIA:

**TELEPHONE:** 020 3600 2255

**EMAIL:** [cservice@oypla.com](mailto:cservice@oypla.com)

**LIVE CHAT:** [www.oypla.com](http://www.oypla.com)

PLEASE RETAIN A COPY OF THESE INSTRUCTIONS FOR FUTURE CONSULTATION

# OYPLA.COM

An Official OYPLA Branded Product