

OYPLATM DIY



Motorcycle Stand

Safety Instructions

Notice: Ensure you read and fully understand instructions before use

While every attempt is made to ensure the highest degree of protection in all equipment, we cannot guarantee freedom from injury. The user assumes all risk of injury due to use. All merchandise is sold on this condition, which no representative of the company can waive or change.

- Make sure all fastenings are tightly in place and that everything is in order before using the product. This should be checked periodically by an adult.
- Do not discard any of the packaging until you have checked that you have all of the parts and fittings required.
- Use the correct fixings as indicated. Do not tighten any of the nuts until the unit is completely assembled, then finish by tightening all nuts. All nuts must be tightened before use.
- Do not carry out alterations or modifications to this product.
- Persons (including children) with reduced physical, sensory and mental capacities or lack of experience and knowledge do not intend this product for use, unless persons responsible for their safety have given them supervision or instruction concerning use of the product.
- If the product is damaged or has any defects, please contact cservice@oypla.com

Assembly Instructions

Parts List:

Please check you have all parts below before attempting to assemble this product.

If you are missing any of the below parts, please contact Oypla customer services:

cservice@oypla.com

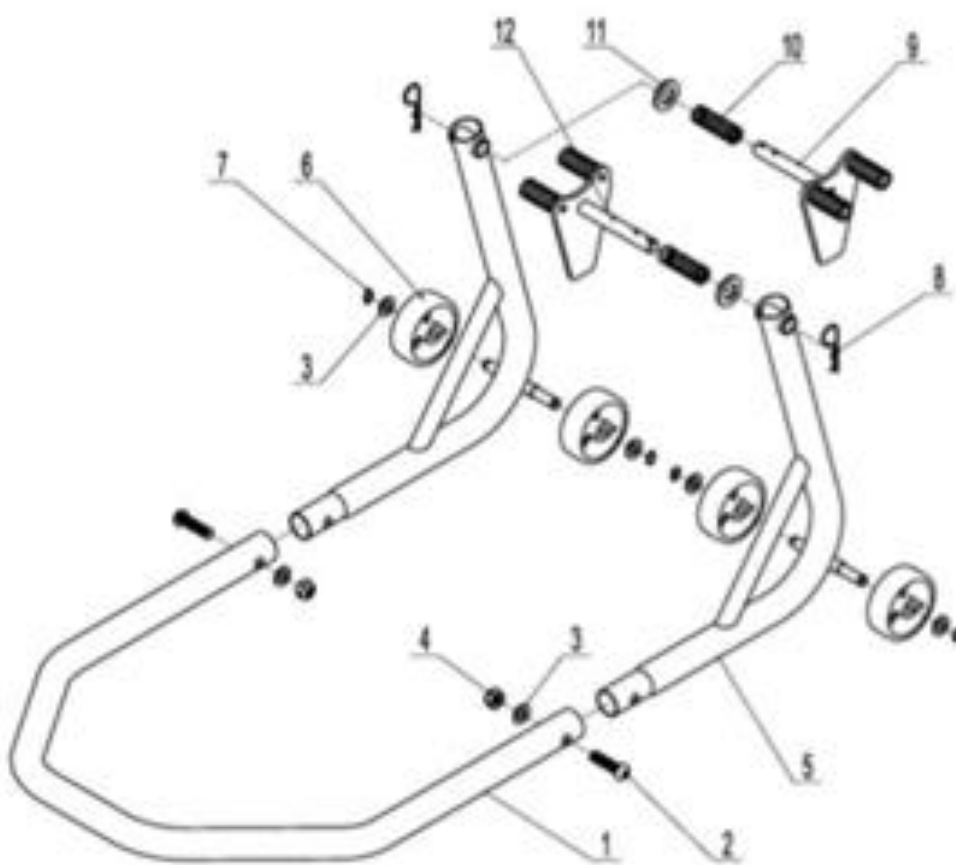

NO.	DESCRIPTION	QTY	NO.	DESCRIPTION	QTY
1	Handle	1	7	Jump Ring Φ 10	4
2	Screw M10*45	2	8	"R" Pin	2
3	Flat Washer Φ 10	6	9	Bobbins Frame(Right)	1
4	Lock Nut M10	2	10	Spring	2
5	Stand Assembly	2	11	Flat Washer Φ 16	2
6	Wheel	4	12	Bobbins Frame(Left)	1

1) Firstly, attach one of the stand assembly (No.5) to one end of the handle (No.1). Ensure the holes align and then secure using a screw, washer and nut (No. 2, 3, 4). Repeat this on the other side of the handle. Please see image on previous page to help.

2) Now take one of the bobbins frames (left (No.12) or right (No.9) and slide a spring and a washer (No.10, 11) onto it. Ensuring these are on the inside, push the cylinder end through the holes at the top of the stand assembly (No.5) and secure in place using an R pin (No.8). Repeat on the other side with the remaining bobbin. Please see image on previous page to help.

HAVE A QUESTION ABOUT YOUR PURCHASE?

OUR DEDICATED CUSTOMER SERVICES TEAM ARE HAPPY TO HELP
CONTACT THEM VIA:

TELEPHONE: 020 3600 2255

EMAIL: cservice@oypla.com

LIVE CHAT: www.oypla.com

PLEASE RETAIN A COPY OF THESE INSTRUCTIONS FOR FUTURE CONSULTATION

OYPLA.COM

An Official OYPLA Branded Product



Imported by Oypla.com LLP, Uxbridge, UB8 2FX

USER MANUAL Model No: 4566

