

LEISURE

THANK YOU FOR YOUR ORDER

Contents

- 1 Front Cover
-
- 2 Safety
Instructions
-
- 3 Operating
Instructions
-
- 5 Trouble
Shooting
-
- 5 Back Cover

End



30L Portable Cool Box

Contents

Safety Instructions

Notice: Ensure you read and fully understand instructions before use

While every attempt is made to ensure the highest degree of protection in all equipment, we cannot guarantee freedom from injury. The user assumes all risk of injury due to use. All merchandise is sold on this condition, which no representative of the company can waive or change.

1	Front Cover
-	-
2	Safety Instructions
-	-
3	Operating Instructions
-	-
5	Trouble Shooting
-	-
5	Back Cover

End

- This product is not a toy, and is only to be used for its designated purpose.
- Do not carry out alterations or modifications to this product.
- Do not discard any of the packaging until you have checked that you have all of the parts and fittings required.
- This product is not intended for use by persons (including children) with reduced physical, sensory and mental capacities, or lack of experience and knowledge, unless they have been given supervision or instruction concerning use of the product by persons responsible for their safety.
- Please ensure the sockets of the cords are inserted firmly. A loose fitting can result in the cord and sockets overheating and failing.
- Do not switch the setting from cool to warm immediately. Change between the settings only after the cooler has been off for 30 minutes.
- Avoid turning the cooler upside down.
- Please note, raw food or seafood cannot be placed on this appliance directly. Packaging for this kind of food is required.
- Clean only with a damp cloth. Do not use strong industrial cleaning substances, as these may damage the product.
- Leaving the product outside exposed to weather, especially direct sun and rain, will speed up the weathering process. This can be slowed down by removing the product from these conditions.
- Please ensure the 12V plug is disconnected from the DC socket after the engine is turned off.
- Keep the appliance away from flammable items, and dampness, to prevent any electrical failure and/or fire.
- Please unplug the 12V plug from the DC socket when the cooler is not in use.
- Prevent any obstructions to the fan. If the fan becomes blocked, it can overheat and cause fire. Never cover with towels or cloths.
- Children should be supervised to ensure they do not play with the appliance.
- Do not use electrical appliances inside the food storage compartments.
- This product is for domestic use only.
- If the product is damaged or has any defects, please contact cservice@oypla.com

Contents

1	Front Cover
-	-
2	Safety Instructions
-	-
3	Operating Instructions
-	-
5	Trouble Shooting
-	-
5	Back Cover
	End

Operating Instructions

Please refer to the diagram below for instructions on how to operate your product.

1. Characteristics of our Products

This electric cool/hot box can bring you cool drinks in the summer and warm food in the winter. No matter whether on a long car journey, or outdoor hiking stuck in your car, you can enjoy plenty of drinks and foods at their optimum temperature. Not only can this product box be used in the car, it can also be used indoors, making transporting this cool/hot box easy due to its lightweight style.

It integrates dual functions of cooling and heating by employing a semiconductor, without compressor or cryogen. It has advantages of being free from pollution (no harmful gasses), small volume, light weight, portable, long service life and lowest power consumption.

2. Application

For holding banquets beside the lake	In students dormitory or dining hall	For travelling by cars
For picnics and on camping trips	In playgrounds	On yacht outing or going fishing
For taxi drivers	In the office or construction	In wagon, truck or travelling

3. Performance

For optimum cooling effect, we suggest using pre-chilled foods and drinks.

This cooler and warmer is not designed to heat cold food but to preserve hot foods at a warm temperature. It can warm to the maximum 50°C – 60°C.

Please note the appliance is not suitable for storing ice cream or to freeze food or beverages.

4. Operating Guide

First make sure the switch at the side of the cooler and warmer is in OFF state, and then insert the plug of the power cord into the socket of the unit

Insert the plug of the cigarette lighter into the cigarette lighter in the car.

Cooling: set the power switch at the position of COOLING. The **green** indicator will be on and indicating the unit is in cooling mode.

Heating: set the switch at position of HEATING. The **red** indicator will be on indicating the unit is in heating mode.

Contents

- 1 Front Cover
-
- 2 Safety Instructions
-
- 3 Operating Instructions
-
- 5 Trouble Shooting
-
- 5 Back Cover

End

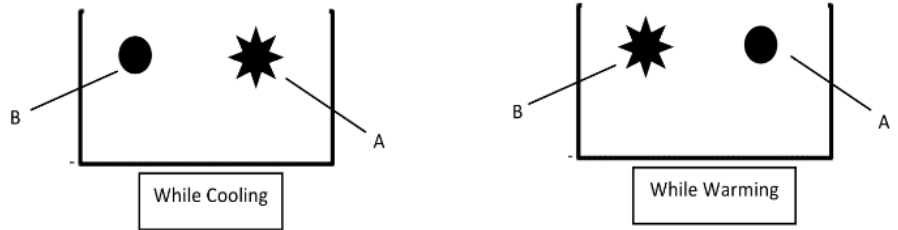

1. Attachment: The different uses between outdoor and

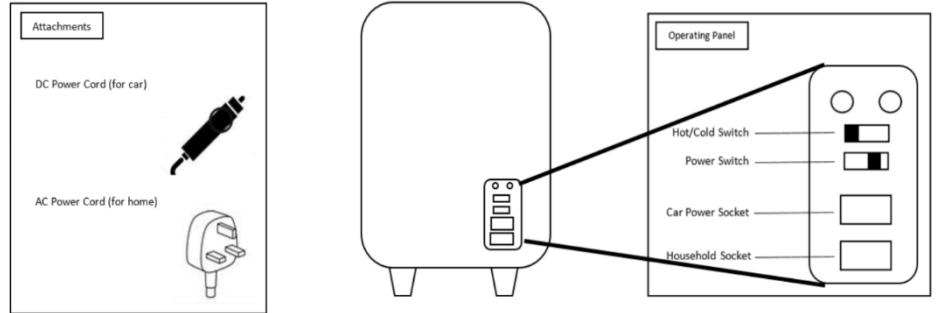

1. When car power is used (DC 12V) – check power rating of car before use

1. Power is drawn from the engine.
2. Insert the plug of DC power

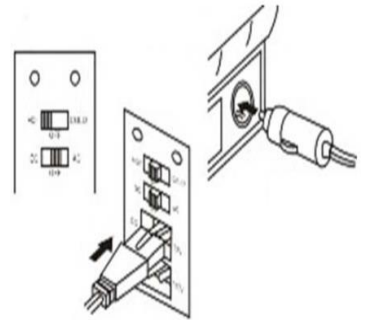

1. When household power is used (AC 220V – 240V)

2. Connect the AC power cord (household power cord) with the household socket of the product.
3. Insert the power socket into the plug.

How to open the cool box?



When opening the box, it is crucial that the handle is in the position seen in the photo to the left. The lid will not open if it is not in this position. Once ready just simply pull up to open.

Contents

1	Front Cover
-	-
2	Safety Instructions
-	-
3	Operating Instructions
-	-
5	Trouble Shooting
-	-
5	Back Cover
	End

Troubleshooting

If the appliance is not cooling or heating	Check if the fan is operational, if it is not, check that the connections are firmly in place. Use a non-metallic brush to clean the connections. Check that the fuse has not blown and that the power is switched on.
If the appliance does not cool and the fan is not rotating.	Contact supplier for advice as the motor may be at fault.
If the appliance does not cool but the fan is rotating normally	Contact supplier for advice as the cooling system may be at fault.
If the appliance does not work when connected to an AC power socket	Contact supplier for advice as the integrated power system may be at fault.



Imported by Oypla.com LLP, Uxbridge, UB8 2FX

HAVE A QUESTION ABOUT YOUR PURCHASE?

Our dedicated customer services team are happy to help. Contact them via:

Telephone: 020 3600 22 55
Email: cservice@oypla.com
Live Chat: WWW.OYPLA.COM

CONSIDER THE ENVIRONMENT!

In the United Kingdom, approximately 5 billion corrugated boxes are used per year, amounting to around 83 per person! By recycling the cardboard box in which this product was packed, you contribute to the preservation and sustainability of the environment.

If you see a recycling logo on the packaging of your product, such as the below examples, that piece of packaging is recyclable. If there is not a recycling logo, please check with your local authorities before recycling.



PLEASE RETAIN A COPY OF THESE INSTRUCTIONS FOR FUTURE CONSULTATION

OYPLA.COM

AN OFFICIAL OYPLA BRANDED PRODUCT

ENVIRONMENTAL PROTECTION

Products bearing the symbol shown below means that used electrical and electronic equipment (WEEE) should not be mixed with general household waste. For proper treatment, recovery and recycling, please take this product(s) to designated collection points where it will be accepted free of charge. Disposing of this product correctly will help save valuable resources and prevent any potential negative effects on human health and the environment, which could otherwise arise from inappropriate waste handling. Please contact your local authority for further details of your nearest designated collection point. Penalties may be applicable for incorrect disposal of this waste, in accordance with your national legislation.



Model Code: 4302

Oypla.com LLP / www.oypla.com