



Out of this world savings.

User Manual

Model: 4220



Water Butt Pump

CE

UK
CA

Contents

Safety Information	2
What's In The Box?.....	3
Assembly Instructions.....	3
Operating Instructions.....	4
Technical Data.....	5
Troubleshooting.....	6

Safety Information

Please ensure you read and fully understand instructions before use

While every attempt is made to ensure the highest degree of protection in all equipment, we cannot guarantee freedom from injury. The user assumes all risk of injury due to use. All merchandise is sold on this condition, which no representative of the company can waive or change.

- This product is not intended for use by persons (including children) with reduced physical, sensory and mental capacities, or lack of experience and knowledge, unless they have been given supervision or instruction concerning use of the product by persons responsible for their safety.
 - Children should be supervised to ensure that they do not play with the product. Always keep children and unauthorised persons out of reach of the appliance.
 - Before use, make sure the connecting socket is not near water.
 - Do not grab the feeder cable, plunge the pump, lift or carry while it is connected to the grid.
 - Make sure all fastenings are tightly in place and that everything is in order before using the product. This should be checked periodically by an adult.
 - Pinch points can cause personal injury.
 - Do not discard any of the packaging until you have checked that you have all of the parts and fittings required.
 - Not suitable for long-run operation.
 - When the appliance is not in use, always unplug from the mains socket.
 - Ensure the power supply to the socket into which the appliance is plugged, is in accordance with the rating label on the appliance and that the socket is earthed.
 - Unpacking, installing and fixing the parts are to be completed by an adult.
 - Do not leave the product unattended while in operation.
 - The temperature of the grained liquid must not exceed +35°C.
 - Visually check the product before use, in particular the feeder cable and plug.
 - To ensure long life of the pump seal, rinse the pump with clean water regularly.
 - To store over winter, make sure there is no water in the appliance.
 - This product is intended for outdoor use only.
 - Do not use the pump for drinking water.
 - If the product is damaged or has any defects, please contact cservice@oypla.com
-

- **Warning!** Ensure to only use splash-proof extension reels that are approved for outdoor use, if an extension reel must be used.
- **Warning!** Ensure to never use this pump for drinking water.

What's In The Box?

Please note that you will be referring to the below parts list during assembly

If any of the below parts are missing or damaged, please contact our dedicated team at cservice@oypla.com.

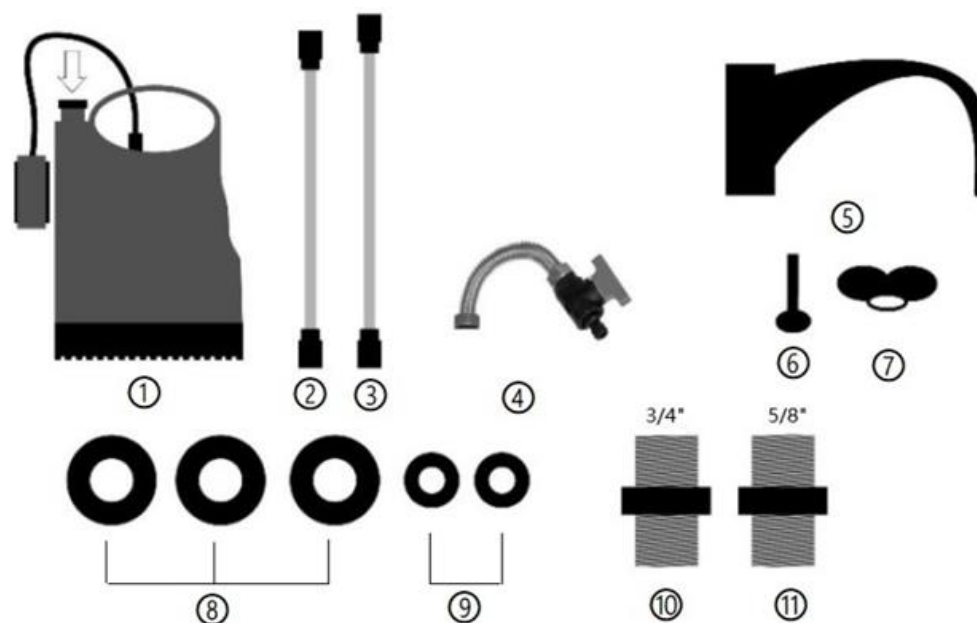

No.	Description	Quantity
1	Base (with float switch and handle)	1pc
2	Middle pole section	1pc
3	Bottom pole section	1pc
4	Hose connector	1pc
5	Handle	1pc
6	Screw (to secure handle)	1pc
7	Accessory (to secure handle)	1pc
8	Flat washer (3/4")	3pcs
9	Flat washer (5/8")	2pcs
10	3/4" Connector	1pc
11	5/8" Connector	1pc

Assembly Instructions

Please refer to the below information to help assemble your Oypla product

If you require assistance with the assembly of your Oypla product, please contact our dedicated team at cservice@oypla.com.

Assembly instruction diagrams follow on the next page

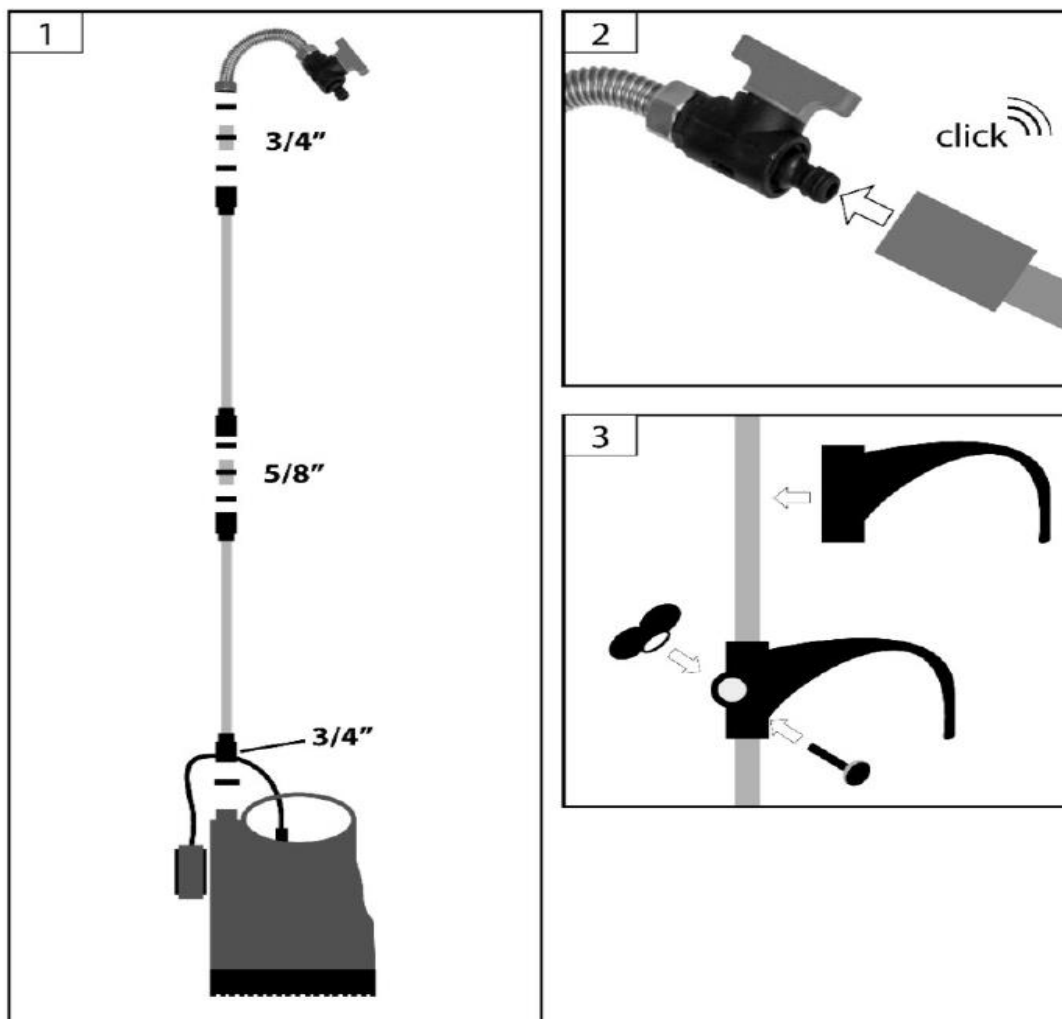

Operating Instructions

The below information is designed to help you with the operation of your Oypla product

If the product is damaged, defective or you require more information, please contact our dedicated team at cservice@oypla.com.

Operating instruction diagrams follow on the next page

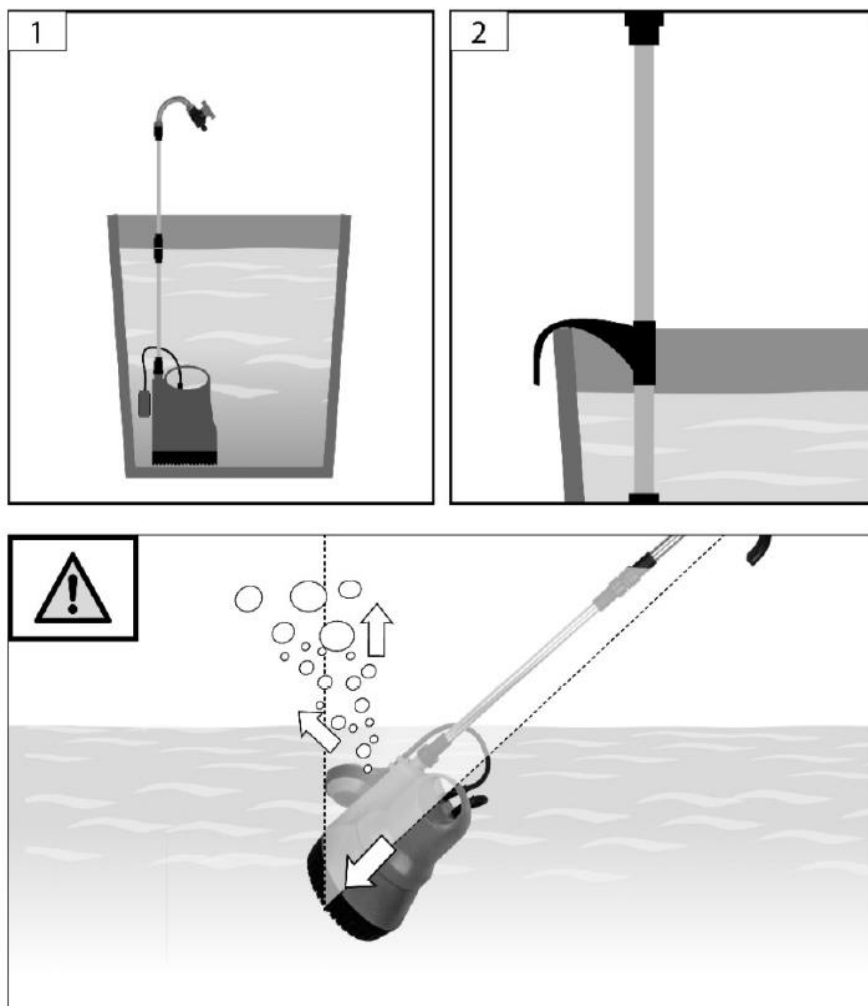

Technical Data

Supply Voltage	220-240V / 50Hz
Rated Power	350W
Max. Immersion Depth	7m
Max. Delivery Head	12m
Max. Flow Rate	2400L/h
Max. Grain Size	3mm
Max. Water Temperature	35 Degrees Celsius
Thread Hose Connection	¾" AG
Protection Class	IPX8
Weight	4.1kg

Troubleshooting

Failure	Likely Causes	Solution
Motor does not start	<ul style="list-style-type: none"> No system voltage Blocked pump wheel Floating switch in shutdown position 	<ul style="list-style-type: none"> Check the voltage Visually inspect the pump wheel for foreign objects Check the water level
Pump does not suck	<ul style="list-style-type: none"> Pump without water Water level too low Blocked pump wheel 	<ul style="list-style-type: none"> Let the air bubbles release Switch the pump off, water level must go up Remove any obstructions
Thermal detector switching off	<ul style="list-style-type: none"> Dirty tube filter Water temperature too high Pump running continuously at maximum pressure 	<ul style="list-style-type: none"> Clean the tube filter and let the pump cool down Reduce the water temperature Make more breaks
Insufficient amount of water pumped	<ul style="list-style-type: none"> Dirty tube filter Water level quickly going down Maximum head of delivery exceeded Transport guide broken 	<ul style="list-style-type: none"> Clean the tube filter Ensure sufficient inflow Check the transport path length Check the transport guide

Have a Question About Your Purchase?

Our dedicated customer services team are happy to help. Contact them via:

Telephone: 020 3600 22 55
Email: cservice@oypla.com
Live Chat: www.oypla.com

Consider the Environment!

By recycling the cardboard box in which this product was packed, you contribute towards helping the environment. If you see a recycling logo such as the below on the packaging, it can be recycled. If a recycling logo is not present, please check with your local authority before recycling.



Environmental Protection

Products bearing the symbol shown below means that used electrical and electronic equipment (WEEE) should not be mixed with general household waste. For proper treatment, recovery and recycling, please take this product(s) to designated collection points where it will be accepted free of charge. Disposing of this product correctly will help save valuable resources and prevent any potential negative effects on human health and the environment, which could otherwise arise from inappropriate waste handling. Please contact your local authority for further details of your nearest designated collection point. Penalties may be applicable for incorrect disposal of this waste, in accordance with your national legislation.



PLEASE RETAIN A COPY OF THESE INSTRUCTIONS FOR FUTURE CONSULTATION

An Official Oypla Branded Product
Imported by Oypla.com LLP, Uxbridge, UB8 2FX

User Manual
Model Code: 4220
Oypla.com LLP / cservice@oypla.com