

OYPLATM DIY



Pressure Washer



Safety Instructions

Notice: Ensure you read and fully understand instructions before use

While every attempt is made to ensure the highest degree of protection in all equipment, we cannot guarantee freedom from injury. The user assumes all risk of injury due to use. All merchandise is sold on this condition, which no representative of the company can waive or change.

- Always wear safety glasses or goggles and protective clothing when operating the machine.
- The product should only be connected to a 240V AC, 50Hz electrical outlet.
- Never leave the product unattended whilst it is switched on.
- If you have to leave the product unattended, even for a short while, always switch it off.
- Keep the product out of children's reach and do not allow children to use it.
- Never use near flammable materials or gasses.
- Always place the machine on a stable surface when using.
- This product is not intended to be connected to portable water mains.
- Keep clear of the nozzle. Never direct high pressure spray at any person, animal or self.
- Always remove the lance from the gun before cleaning debris from the tip.
- Inspect the mains lead regularly. Never use the product if the mains lead or plug has been damaged in any way.
- Do not place the mains lead on or near any hot surface.
- Only use this product in the manner and for the functions described in this manual.
- The operator or user of this product is responsible for any accidents or hazards occurring to other people or their property during its use.
- Use the product only in daylight or good artificial light.
- Keep the operation area clear of all persons.
- Do not overreach or stand on an unstable surface. Keep good footing and balance at all times.
- Never try to stop or deflect leaks with any body part.
- Always engage the trigger safety latch in the safe position, even when spraying is stopped for a moment.
- Do not use pressure that exceeds the operating pressure of any of the parts (hoses, fittings, etc.) in the pressurized system. Ensure that all equipment and accessories are rated to withstand the maximum working pressure of the unit.

- Do not spray electrical apparatus or wiring.
- Never disconnect the high-pressure discharge hose from the machine while the system is pressurized. To depressurize the machine, turn the power and water supply off, then press the gun trigger 2-3 times.
- Never permanently engage the trigger mechanism on the gun.
- Never operate the machine without all components properly connected to the machine (handle, gun, nozzle, etc.).
- Always turn water supply on before turning the pressure washer on. Running the pump dry will cause serious damage.
- Do not operate the pressure washer with the inlet water screen removed. Keep screen clear of debris and sediment.
- Never operate the washer with broken or missing parts. Check equipment regularly and repair or replace worn or damaged parts immediately.
- Use only the nozzle supplied with his machine.
- Always hold the gun and wand firmly when starting and operating the machine.
- Never allow the unit to run with the trigger released (off) for more than one minute.
- Be aware of the recoil caused by the water jet when the machine is switched on.
- Keep the hose away from sharp objects. Bursting hoses may cause injury. Examine the hose regularly and replace it if damaged. Do not attempt to repair a damaged hose.
- This pressure washer is not designed to pump hot water. Never connect it to a hot water supply as it will significantly reduce the life of the pump.
- Never store the pressure washer outdoors or where it could freeze. The pump will be seriously damaged.
- Release the trigger when changing from high to low pressure modes. Failure to do so could result in damage.
- The use of extension cord is not recommended. Use only extension cords intended for outdoor use. Use only extension cords having an electrical rating equal to, or more than, the rating of this machine
- If the product is damaged or has any defects, please contact cservice@oypla.com

Assembly Instructions

Parts List:

If you are missing any of the below parts please contact

cservice@oypla.com

Please be aware that you will be referring to this parts list throughout the assembly process.

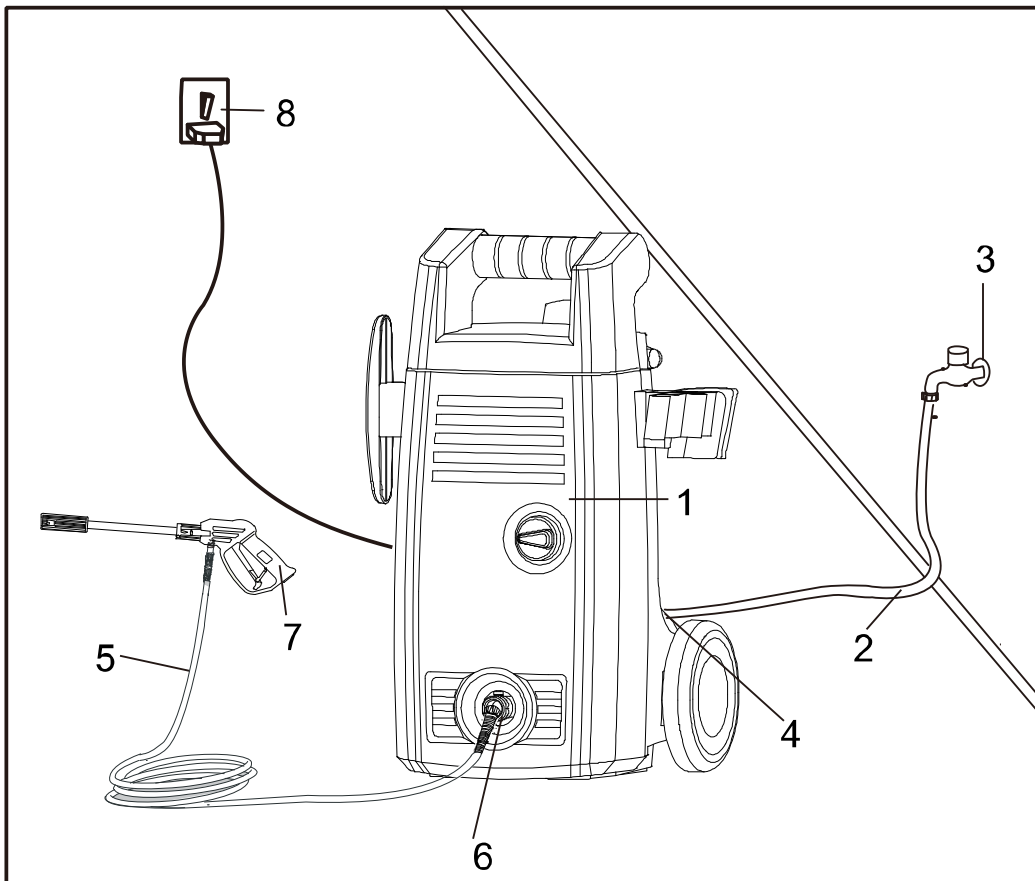

1. Pressure washer
2. Water connection
3. Water inlet
4. High Pressure Hose
5. Water Outlet
6. Spray Gun
7. Power Supply

Assembly Steps

1. Insert the cable hook holder onto the machine.
2. Align the holes on the bottom of the pressure cleaner as shown and tighten the two screws.
3. Fit the wheels to the machine as shown.
4. Attach the high-pressure hose to the pressure water outlet of the machine.
5. Attach the spray handle onto the high-pressure hose. Prior to operating the machine, ensure that the high-pressure hose has been completely uncoiled. Whilst the machine is in operation the hose must not loop.
6. Mount the nozzle or any other equipment desired to the hose.

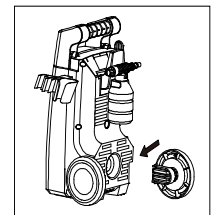
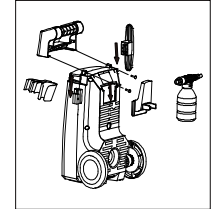
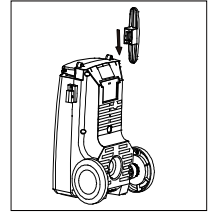

Adjusting Fan Pattern

The angle of spray coming from the lance can be adjusted by rotating the nozzle. This will vary the spray pattern from approximately a 0° narrow high impact stream to a 60° wide fan spray.

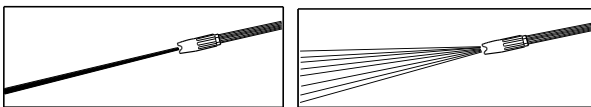
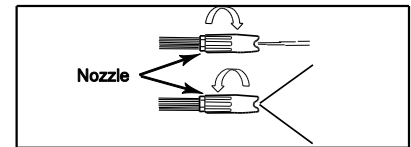

A narrow stream has high impact force on the cleaning surface and results in maximum deep cleaning in a concentrated area. However, this narrow high impact spray must be used cautiously, as it may damage some surfaces.

A wide fan pattern will distribute the impact of the water over a larger area, resulting in excellent cleaning action with a reduced risk of surface damage. Large surfaces areas can be cleaned more quickly using a wide fan pattern.

Nozzle Cleaning Instructions

A clogged or partially clogged nozzle can cause a significant reduction of water coming out of the nozzle and cause the unit to pulsate while spraying. To clean the nozzle:

- Turn off and unplug the unit.
- Turn off water supply. Relieve any pressure trapped in the hose by squeezing the trigger 2-3 times.
- Separate the lance from the gun.
- Rotate nozzle to the narrow stream setting. This opens up the fan blades.
- Using the included tip cleaner, or an unfolded paper clip, insert wire into the nozzle hole and move back and forth until debris is dislodged.

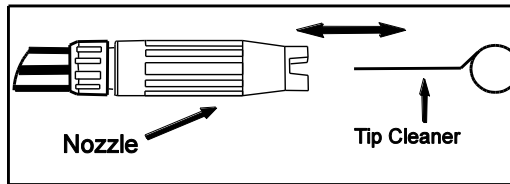

- Remove additional debris by back-flushing water through the nozzle. To do this, place the end of a garden hose (with water running) to the end of the nozzle for 30-60 seconds.

Operating Instructions

1. Surface Preparation

Before starting a pressure wash cleaning job, it is important to prepare the surface that is to be cleaned. This is done by cleaning the area of furniture, and making sure that all windows and doors are closed tight. In addition, you should make sure that all plants and trees adjacent to the cleaning area are protected by a drop cloth. This will ensure that your plants won't be sprayed by detergents.

2. Initial High Pressure Rinse

Spray the cleaning surface with water to clear off any dirt or grime that may have collected on the surface. This will allow your detergent to attack the deep-down dirt that has worked its way into the cleaning surface. Before triggering the gun, adjust the nozzle to a wide fan pattern and slowly adjust to the desired pattern. This will help you avoid applying too much concentrated spray to the surface which could cause damage.

3. Detergent Application

NOTE: Use only detergents formulated for pressure washers.

NOTE: Test detergent in an inconspicuous area before use.

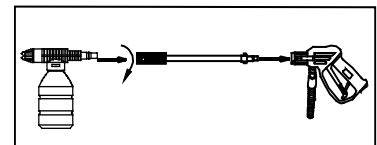

- Unscrew the top of the detergent applicator and fill with detergent.
- Replace the top on the applicator.
- Remove the lance from the gun.
- Attach the detergent applicator to the gun.
- Apply the detergent so it thoroughly covers the cleaning surface. Apply from bottom to top to prevent detergent from sliding down and streaking.
- Allow the detergent to remain on the surface for a few minutes. This is a good time to use a brush to lightly scrub heavily soiled areas. Never allow detergent to dry on the cleaning surface.
- Remove the detergent applicator from the gun and replace with the lance, or remove the applicator from the end of the lance.
- Rinse the detergent from the surface.

NOTE: Flush the detergent applicator with clear water following each use.

4. Final Rinse

Start the final rinse at the bottom of the surface and work upwards. Make sure that you thoroughly rinse the surface and that all detergent has been removed.

5. Shutdown

1. Be sure that all detergent is flushed from the system.
2. Turn off the motor.
3. Turn off the water supply.
4. After the motor and water supply have been turned off, trigger the gun to depressurize the system.

WARNING: Never turn the water supply off before turning the motor off. Serious damage could occur to the pump and/or motor.

WARNING: Never disconnect the high-pressure discharge hose from the machine while the system is pressurized.

5. After each use, wipe all surfaces of the pressure washer with a clean, damp cloth.

6. Storage

Do not store the pressure washer outdoors.

Do not store the pressure washer where it might freeze.

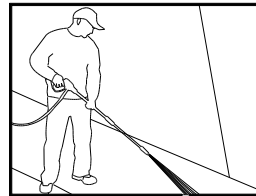

Care and Maintenance

- Never operate the unit without water.
- The pressure washer is not meant to pump hot water. Never connect to a hot water supply – this will significantly reduce the life of the pump.
- Using detergents other than specified pressure washer detergent may cause damage to pump components. This also applies to chemicals such as bleach, dish soap, etc.
- Never operate the washer for more than one minute without spraying water. Resulting heat build-up will damage the pump.
- Before adjusting the nozzles pressure (high-to-low or low-to-high), release the trigger.

Environmental Protection

Products bearing the symbol shown above means that used electrical and electronic equipment (WEEE) should not be mixed with general household waste. For proper treatment, recovery and recycling, please take this product(s) to designated collection points where it will be accepted free of charge. Disposing of this product correctly will help save valuable resources and prevent any potential negative effects on human health and the environment, which could otherwise arise from inappropriate waste handling. Please contact your local authority for further details of your nearest designated collection point. Penalties may be applicable for incorrect disposal of this waste, in accordance with your national legislation.

Please retain a copy of all instructions for future consultation.



An Official Oypla Branded Product

Imported into the EU by Oypla.com LLP, Uxbridge, UB8 2FX

