

# OYPLA<sup>TM</sup>

## DIY



# Chisel Set

USER MANUAL Model No: 4095

# Safety Instructions

## **Notice: Ensure you read and fully understand instructions before use**

While every attempt is made to ensure the highest degree of protection in all equipment, we cannot guarantee freedom from injury. The user assumes all risk of injury due to use. All merchandise is sold on this condition, which no representative of the company can waive or change.

- Ensure that your work area is clean and well lit. Cluttered or dark areas increase the risk of personal injury.
- Ensure that children and bystanders are kept away while using a chisel. Distractions can cause you to lose control.
- Dress appropriately. Do not wear loose clothing or jewelry. Hair should be tied back and suitable clothing and gloves should be worn.
- Use personal protective equipment. Always wear eye protection and protective gloves.
- Never hold the piece to be cut in your hand or across your legs. Always secure the work piece to a suitable stable platform.
- Always check the wood thoroughly for staples, knots, nails, screws or other foreign objects before chiseling.
- Stay alert, watch what you are doing and use common sense when using a chisel. Do not use when tired or under the influence of drugs, alcohol or medication. A moment of inattention while using may result in serious injury to yourself or others.
- Do not force the chisel. Use the correct chisel for your operation. The correct chisel will do the job better and more safely at the rate for which it was designed.
- When the blade is binding, or when interrupting a cut for any reason, you will need to sharpen the chisel.
- This product is not a toy, and is only to be used for its designated purpose.
- If the product is damaged or has any defects, please contact [cservice@oypla.com](mailto:cservice@oypla.com)

# Operating Instructions

**Notice: Please ensure that all parts are included before disposing of the packaging**

- Ensure that cutting edges are kept sharp. Sharpen as often as necessary.
- Use a wooden or plastic mallet with a large striking face on all chisels. Only heavy duty or framing chisels can be struck with a steel hammer.
- Make finishing or paring cuts with hand pressure alone.
- When keeping the chisels on the work bench, always place them with the bevel side up.
- Place chisels safely within the protective cover to cover the cutting edges when not in use.
- Do not use any chisel that is bent or shows dents, cracks, chips or excessive wear.
- Do not use if the handle is broken or splintered.
- Do not use a wood chisel as a pry or wedge.
- Do not use a wood chisel on metal.
- Do not use a chisel with a mushroomed face or a chipped edge. Redress with the stone supplied.
- Do not use a grinder to sharpen, use the honing stone supplied.

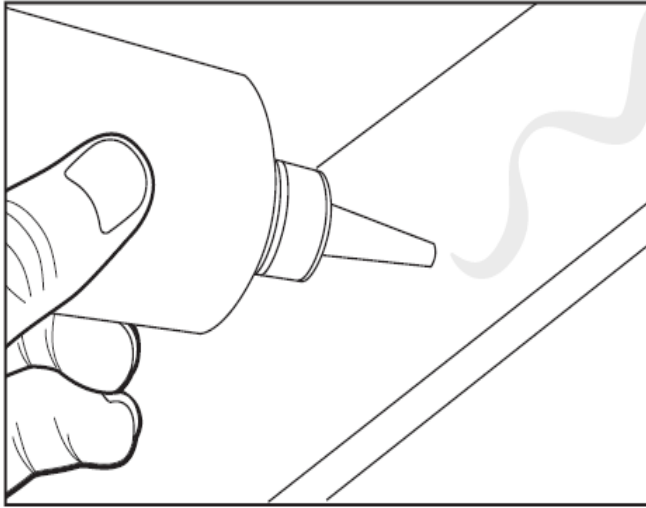

1. Ensure the sharpening stone is secure.
2. Lubricate with a suitable type of oil.

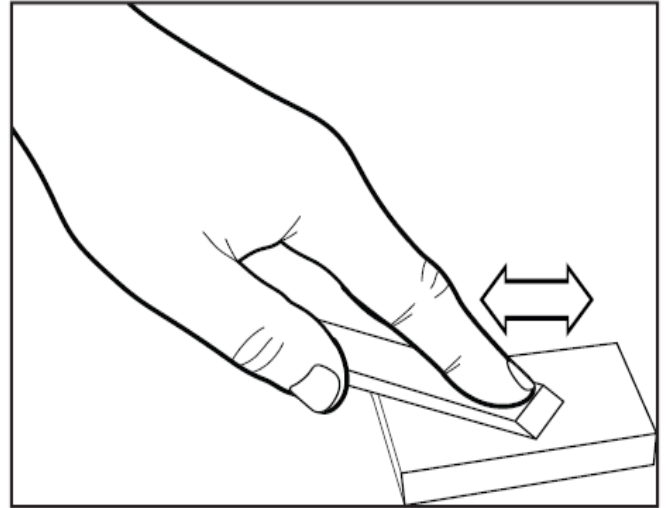

3. Place the back of the chisel (flat side down) against the stone and rub back and forth.

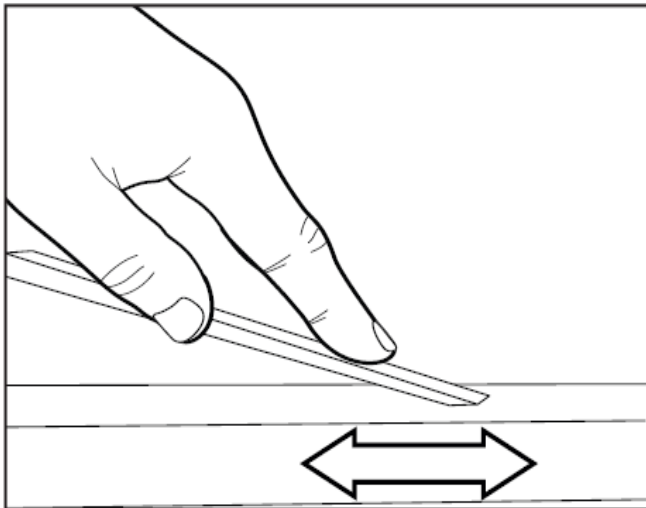

4. Turning the chisel over, rest the bevel side onto the stone.
5. Use the supplied honing guide to achieve the best results.
6. Make a few passes across the stone and inspect.
7. If the tip is scratched, the angle is too large. If the heel is just scratched, the angle is too small. When the entire bevel is scratched, this is the correct angle.

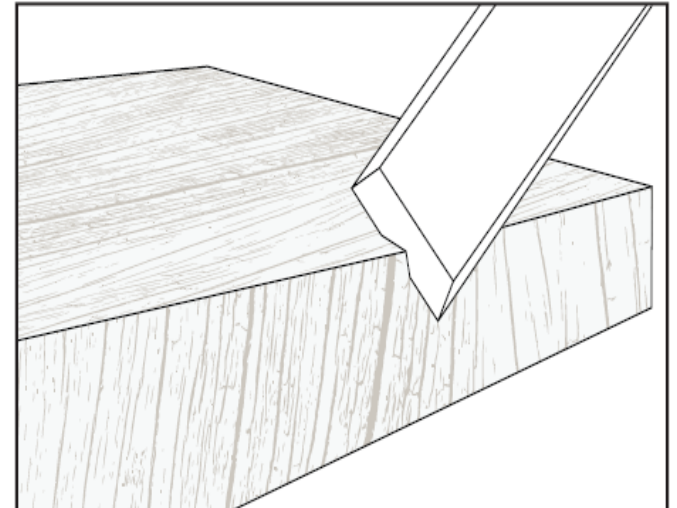

8. Once you have your chisel sharpened to the desired angle, use a piece of scrap wood and slide the edge of the chisel along the edge of the wood to remove the burr.

**HAVE A QUESTION ABOUT YOUR PURCHASE?**

OUR DEDICATED CUSTOMER SERVICES TEAM ARE HAPPY TO HELP  
CONTACT THEM VIA:

**TELEPHONE:** 020 3600 2255

**EMAIL:** [cservice@oypla.com](mailto:cservice@oypla.com)

**LIVE CHAT:** [www.oypla.com](http://www.oypla.com)

PLEASE RETAIN A COPY OF THESE INSTRUCTIONS FOR FUTURE CONSULTATION

**OYPLA.COM**

An Official OYPLA Branded Product

Imported by Oypla.com LLP, Uxbridge, UB8 2FX

**USER MANUAL Model No: 4095**