



PLEASE READ THIS USER'S MANUAL THOROUGHLY BEFORE USE

# **USER MANUAL**

## **2-in-1 VACUUM CLEANER**

**MODEL NO.: 3971**



## **SAFETY INSTRUCTIONS** (Please keep these instructions)

Please read the entire instruction manual before using the product and then save it for future reference. We reserve the right for any errors in text or images and any necessary changes made to technical data. In the event of technical problems or other queries, please contact our Customer Services.

- The product should only be connected to a 240 V AC, 50 Hz electrical outlet.
- Never leave the product unattended whilst it is switched on.
- If you have to leave the product unattended, even for a short while, always switch it off.
- Keep the product out of children's reach and do not allow children to use it.
- Never use near flammable materials or gasses.
- Inspect the mains lead regularly. Never use the product if the mains lead or plug has been damaged in any way.
- Do not place the mains lead on or near any hot surface.
- Do not touch the product if your hands are moist or wet.
- This product is intended for domestic household use only.
- Do not operate the vacuum too close to heater, radiators or cigarette butts.
- Before you start vacuuming, make sure to remove any large or sharp objects that might damage the filter
- Do not vacuum anything that is burning or smoking such as cigarettes, matches or hot ashes
- Do not let foreign objects enter the soldering gun as this may cause internal damage.
- Use extra care when cleaning on stairs.
- Do not use the vacuum without the dust filter in place.

### **⚡ WARNING ⚡**

To Reduce The Risk of Fire or Electric Shock, follow these basic precautions:

- Read all instructions before using this tool.
- Never allow children to operate or play with this tool.
- Do not store or use gasoline or any other flammable vapors and liquids in the vicinity of this tool. The fumes can create a fire hazard or explosion.
- UNPLUG OR DISCONNECT THIS TOOL FROM THE POWER SUPPLY BEFORE SERVICING.

**-Save these instructions-**

## SAFETY INSTRUCTIONS (Please keep these instructions)

### Product Details

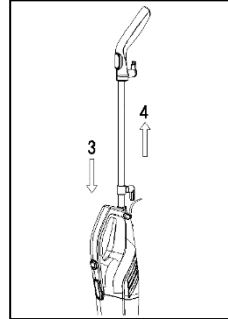
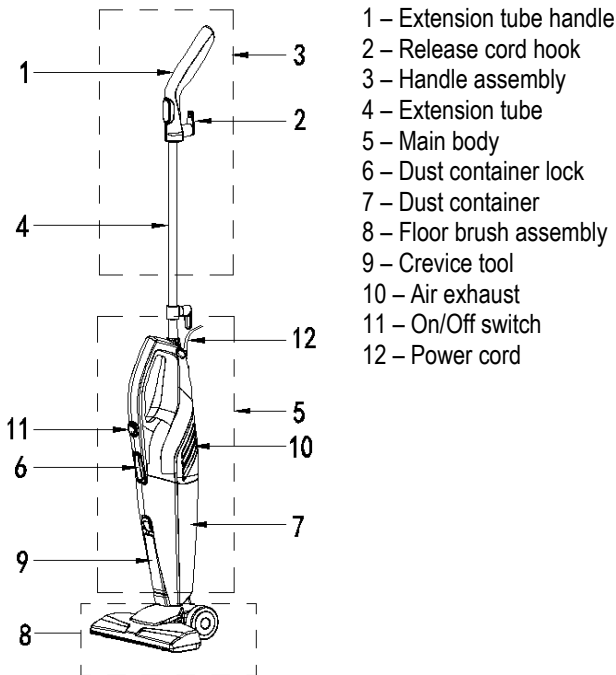

To detach the extension tube, press the release button on the side of the side of the vacuum cleaner and pull out (fig.5).

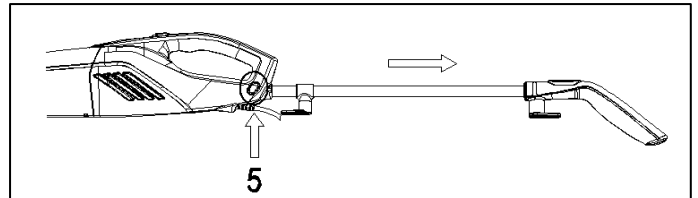

### Operating Instructions

#### Inserting the Handle into the Main Body

Hold the vacuum and extension tube, making sure the spring-loaded button (fig.1) on the handle is in line with the hole on the main body (fig.2). Press the button down and insert the handle into the body.

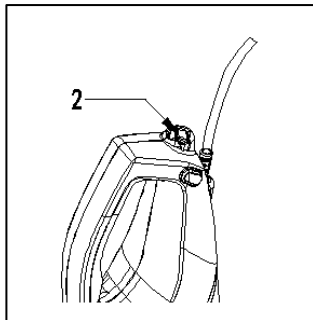
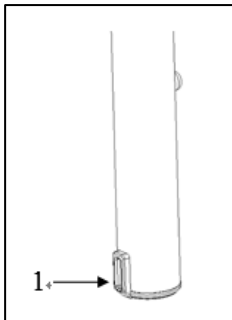

Push the tube into the vacuum cleaner until you hear it click. The tube will then be locked into place (fig.3). Pull the handle upwards to ensure the tube is properly secured (fig.4).

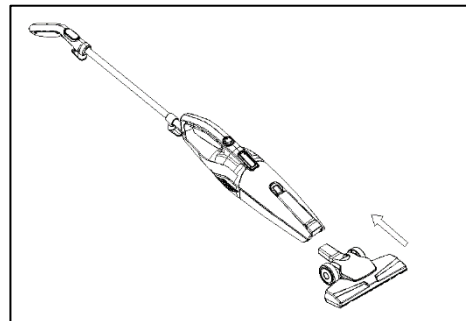

#### Attaching the Floor Brush to the Main Body

Push the floor brush into the suction hole opening.

#### Using the Crevice Tool

Push the end of the crevice tool (fig.6) back and turn it 180° (fig.7). Push the other end of the crevice tool into the suction hole (fig.8).

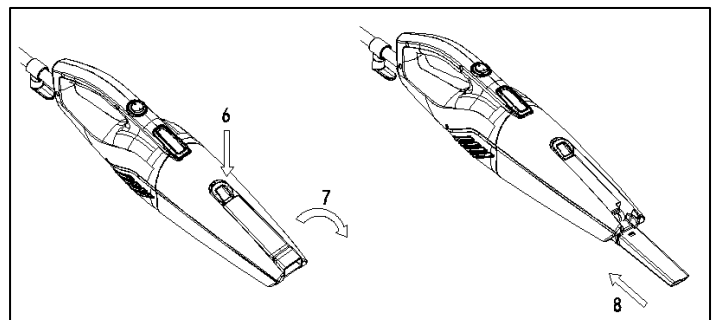

## USER INSTRUCTIONS (Please keep these instructions)

### Winding & Unwinding the Power Cord

This vacuum cleaner is equipped with a convenient cord storage feature. The unit also has a quick release hook.

- Wind the power cord around the quick release hook and the cord winding hook (fig.9 & fig.10).
- To unwind the power cord, simply twist the quick release hook to the left or right.

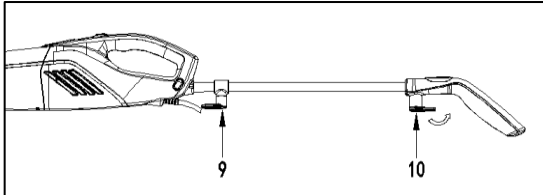

### Power Switch

- The On/Off power switch has two different positions (fig.11).
- Push on the "I" side to turn the vacuum ON.
- Push on the "O" side to turn the vacuum OFF.

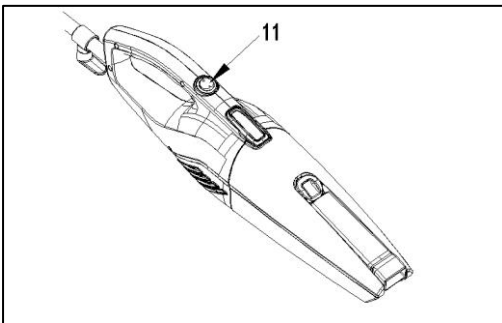

### Using the Unit as an Upright

1. Insert the extension tube into the main body.
2. Choose the appropriate accessory (crevice tool or floor brush) and attach it to the suction hole opening.
3. Press the "I" position on the On/Off power switch (fig.11) to turn the unit on.

### Using the Unit as a Hand Vacuum

Disconnect the extension tube from the vacuum by releasing the handle port from the locking slip and removing the extension tube from the hand vacuum handle. Once the extension tube is removed, snap the handle port shut.

### Cleaning & Changing the Dust Cup Filter

In order to achieve the best performance, empty the dust container and clean the filter after each use.

1. To remove the dust container, press down on the release button (fig.12) and separate the dust container from the main body (fig.13).

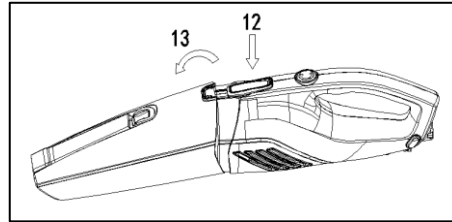

2. Pull out the filter assembly (fig.14), then twist the filter frame to take out the filter (fig.15).

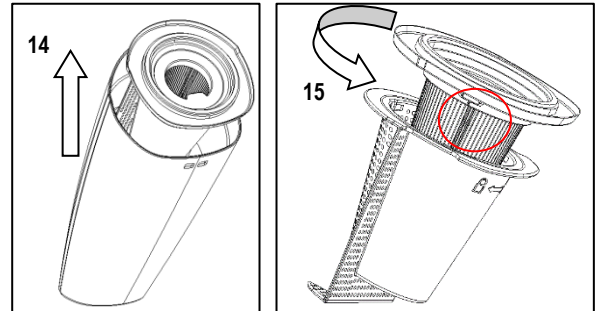

3. Empty the dust from the dust container.
4. Rinse the dust filter in cold water, and then let it dry naturally for 24 hours before placing it back in the dust container.

**NOTE: Do not use a washing machine to clean the dust filter. Do not use a hair dryer to dry it.**

5. Place the dust cup filter carefully into the dust container. Never operate the vacuum without the filter in place.
6. Attach the dust container to the main body of the unit.

## USER INSTRUCTIONS (Please keep these instructions)

### Troubleshooting

Issue	Reason	Solution
Vacuum will not operate.	No power in electrical outlet.	Check fuse or circuit breaker. Replace fuse/reset breaker.
Vacuum will not pick-up or suction power is weak.	Dust container full.	Empty the dust container.
	Dust filter needs cleaning or replacement.	Remove dust filter and check for objects in the air duct and remove. Clean or replace filter.
Dust escaping from vacuum	Dust container full.	Empty the dust container.
	Dust filter is not installed correctly.	Check the dust filter installation instructions.
	Puncture/hole in dust filter.	Replace the dust filter.

### Disposal of Unit

Appliances bearing the symbol shown here may not be disposed of in domestic rubbish. You are required to dispose of old electrical and electronic appliances like this separately. Please visit [www.recycle-more.co.uk](http://www.recycle-more.co.uk) or [www.recyclenow.co.uk](http://www.recyclenow.co.uk) for access to information about the recycling of electrical items. Please visit [www.weeeireland.ie](http://www.weeeireland.ie) for access to information about the recycling of electrical items purchased in Ireland. The WEEE directive, introduced in August 2006, states that all electrical items must be recycled, rather than taken to landfill. Please arrange to take this appliance to your local Civic Amenity site for recycling, once it has reached the end of its life.



**An Official Oypla Branded Product**



Imported into the EU by Oypla.com LLP, Uxbridge, UB8 2FX