



72L Lawn Roller

Safety Instructions

Notice: Ensure you read and fully understand instructions before use

While every attempt is made to ensure the highest degree of protection in all equipment, we cannot guarantee freedom from injury. The user assumes all risk of injury due to use. All merchandise is sold on this condition, which no representative of the company can waive or change.

- Before using the lawn roller, make sure all fastenings are tightly in place and that everything is in order, and checked periodically.
- This lawn roller is not a toy, and is only to be used for its designated purpose.
- This product is not suitable for use by children.
- If at any time during activity you feel faint, dizzy or experience pain, stop and consult your physician or doctor.
- This product is intended for outdoor use only.
- This product includes small parts that could cause choking.
- Clean only with a damp cloth. Do not use strong industrial cleaning substances.
- Leaving the lawn roller outside exposed to weather, especially direct sun, rain and salt air, will speed with weathering process. This can be slowed by removing the roller from these conditions, or covering it with a suitable cover.
- When using the lawn roller, it is essential that you keep your hands and feet clear of the heavy drum.
- Special care is necessary when using the lawn roller on a slope.
- If the product is damaged or has any defects, please contact cservice@oypla.com

Weight when filled with sand **120kg**.

Weight when filled with water **72kg**.

Assembly Instructions

Parts List:

If you are missing any of the below parts please contact cservice@oypla.com

Please be aware that you will be referring to this parts list throughout the assembly process.

No.	Part Name	Quantity
1	Drum	1
2	Handle (with sponge)	1
3	Bottom Section	1
4	Scraper	1
5	M8 Bolt	4
6	Nut	4
7	Drum Nut	2
8	Washer	2

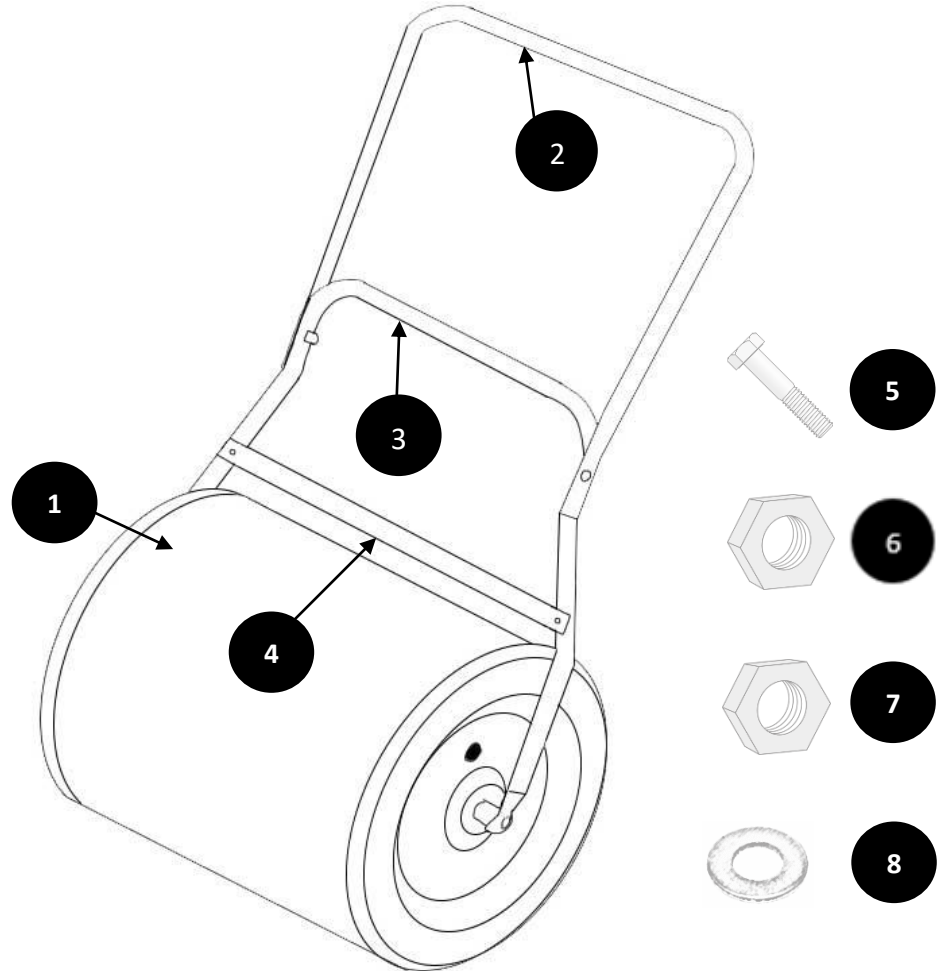

Before commencing, check that you have all the components: roller drum (1); handle (with sponge) (2) bottom section (3); scraper (4); fixings (5, 6, 7, 8).

Do not tighten fixings until all nuts and bolts are in the correct position

Step 1:

- Assemble the bottom section (3) to the Handle (with sponge) (2) with one M8 bolt (5) and one nut (6) on each side.
- Attach the bottom section to the drum axle, using a washer (8) and drum nut (7) on either side to secure drum to bottom section. **Force may be needed to secure.**

Step 2:

- Attach the scraper (4) to the bottom section using the remaining two M8 bolts (5) and nuts (6).

Step 3:

- Check the handle is square and the scraper is not touching the roller drum and then tighten all the fixings.

Step 4:

- Turn the roller drum so that the cap is upwards and then fill with water or for a heavier roller use sand.

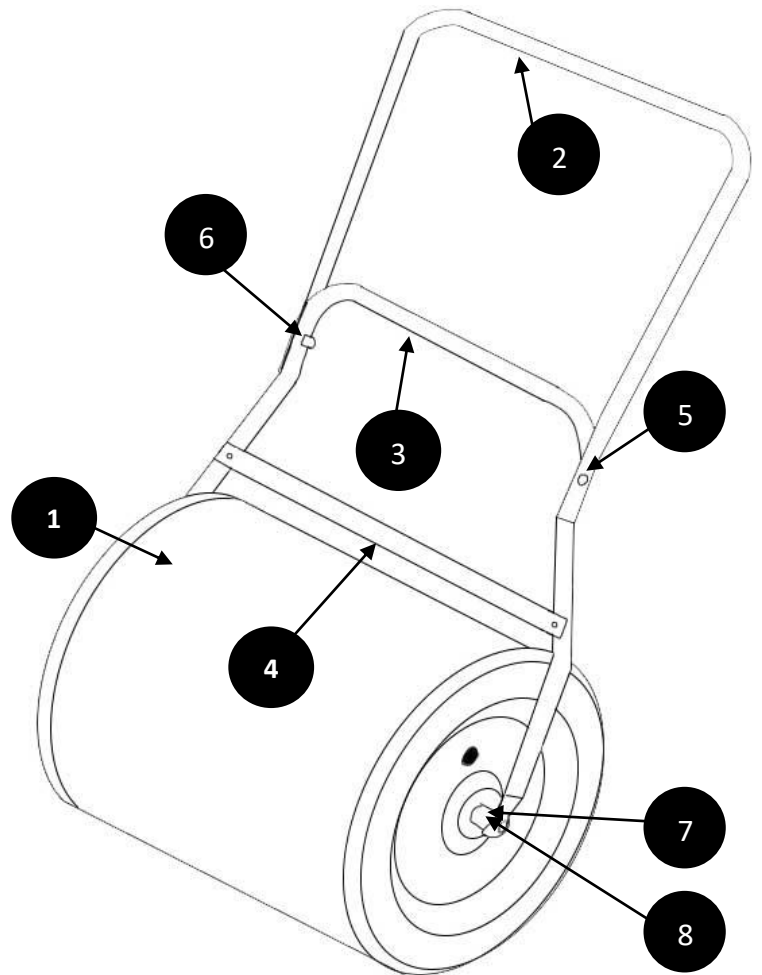

Use the lawn roller when seeding a new lawn or after cutting to improve the overall appearance of the lawn. Rolling will spread the grass roots giving a thicker coverage. Rolling is advised every time the lawn is cut.

HAVE A QUESTION ABOUT YOUR PURCHASE?

OUR DEDICATED CUSTOMER SERVICES TEAM ARE HAPPY TO HELP
CONTACT THEM VIA:

TELEPHONE: 020 3600 2255

EMAIL: cservice@oypla.com

LIVE CHAT: www.oypla.com

PLEASE RETAIN A COPY OF THESE INSTRUCTIONS FOR FUTURE CONSULTATION

OYPLA.COM

An Official OYPLA Branded Product

Imported by Oypla.com LLP, Uxbridge, UB8 2FX

USER MANUAL Model No: 3933