

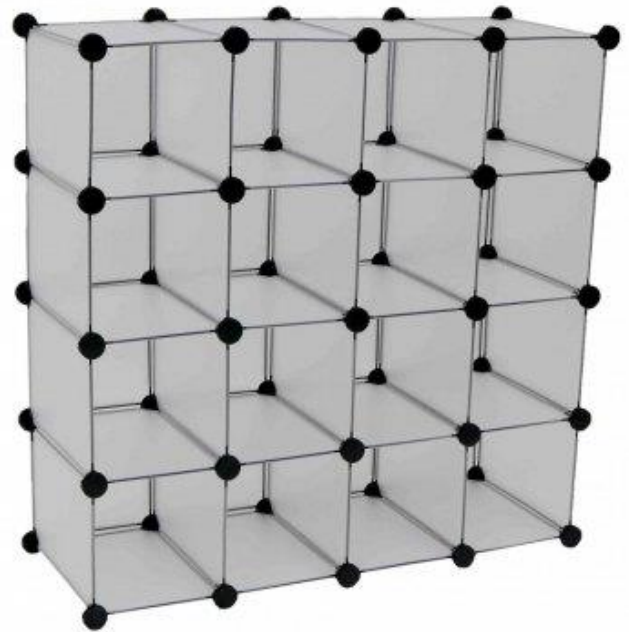

HOME

THANK YOU FOR YOUR ORDER



*Colour may vary

Interlocking 16 Compartment Shoe Cube

Safety Instructions

Notice: Ensure you read and fully understand instructions before use

While every attempt is made to ensure the highest degree of protection in all equipment, we cannot guarantee freedom from injury. The user assumes all risk of injury due to use. All merchandise is sold on this condition, which no representative of the company can waive or change.

- Make sure all fastenings are tightly in place and that everything is in order before using the product. This should be checked periodically by an adult.
- Do not discard any of the packaging until you have checked that you have all of the parts and fitting required.
- Use the correct fixings as indicated.
- This product is not a toy, and is only to be used for its designated purpose.
- This product contains small parts that could be a choking hazard if swallowed. Keep these items away from children.
- Do not carry out alterations or modifications to this product.
- Clean only with a damp cloth. Do not use strong industrial cleaning substances or abrasive materials as these will damage the product.
- Children should be supervised to ensure they do not play with the product.
- Make sure that all platforms are secure before applying any weight to the product.
- This product is intended for indoor use only.
- Only use this product on stable, level and dry ground.
- This product is for domestic use only.
- If the product is damaged or has any defects, please contact cservice@oypla.com.

Assembly Instructions

Parts List:

Please check you have all parts below before attempting to assemble this product.

If you are missing any of the below parts, please contact Oypla customer services:

cservice@oypla.com

<u>NAME:</u>
SQUARE PANELS
SIDE PANELS
CONNECTOR DISCS

1. To begin, place one of the square panels on the floor. This will form the back of your shoe organiser, once brought to its upright position.

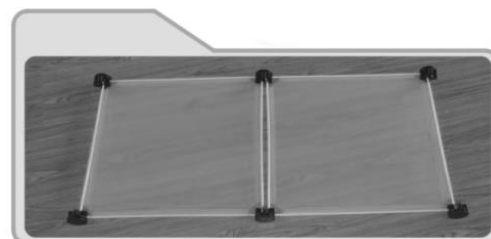

2. Slide a connector disc onto each corner of the square, ensuring that the cross shaped slot is facing upwards. (Each connector disc has four right angled hollows beneath the smooth side and the cross shaped side where the corners of the square panel slot in.)

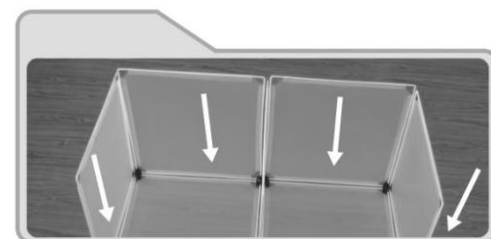

3. Connect another square panel alongside the original square panel by sliding it into the remaining hollows in the connector discs.

4. Add more connector discs and square panels until you have achieved the shape you require, remembering that the shoe organiser is lying down and these squares will form the back once it is brought upright.

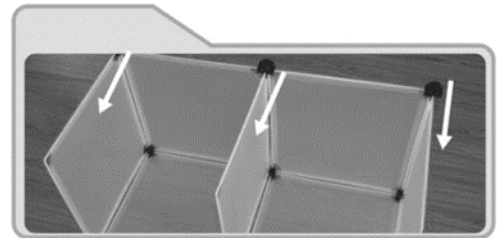

5. Once you have assembled the back of the shoe organiser, you can insert the side panels to divide the shoe organiser by pushing them down into the upwards-facing cross shaped slots in the connector discs.

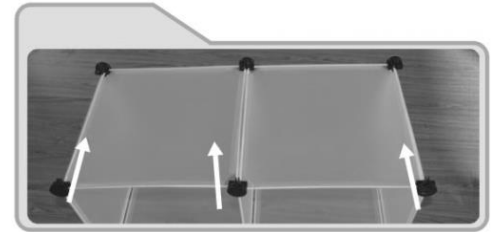

6. Once you have added all the side panels you can secure the panels in place by clipping the remaining connector discs onto the corners of each box you have formed – this time the cross shaped slots will be facing inwards.

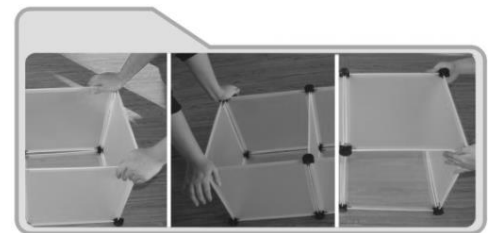

7. When you have finished, lift the shoe organiser into its upright position. Apply pressure to all the joints ensuring all the panels are clicked onto place and to correct any misshaping.

HAVE A QUESTION ABOUT YOUR PURCHASE?

Our dedicated customer services team are happy to help. Contact them via:

Telephone: 020 3600 22 55
Email: cservice@oypla.com
Live Chat: WWW.OYPLA.COM

CONSIDER THE ENVIRONMENT!

In the United Kingdom, approximately 5 billion corrugated boxes are used per year amounting to around 83 per person! By recycling the cardboard box in which this product was packed, you contribute to the preservation and sustainability of the environment.

If you see a recycling logo on the packaging of your product, such as the below examples, that piece of packaging is recyclable. If there is not a recycling logo, please check with your local authorities before recycling.



PLEASE RETAIN A COPY OF THESE INSTRUCTIONS FOR FUTURE CONSULTATION

OYPLA.COM

AN OFFICIAL OYPLA BRANDED PRODUCT