



Heavy Duty Snow Shovel

Safety Instructions

Notice: Ensure you read and fully understand instructions before use

While every attempt is made to ensure the highest degree of protection in all equipment, we cannot guarantee freedom from injury. The user assumes all risk of injury due to use. All merchandise is sold on this condition, which no representative of the company can waive or change.

- This product contains small parts that could be a choking hazard if swallowed. Keep these items away from children.
- If at any time during use you feel faint, dizzy or experience pain, stop and consult your physician or doctor.
- Make sure all fastenings are tightly in place and that everything is in order before using the product. This should be checked periodically by an adult.
- This product is not a toy, and is only to be used for its designated purpose.
- Do not carry out alterations or modifications to this product.
- Children should be supervised at all times when using the product.
- Clean only with a damp cloth. Do not use strong industrial cleaning substances.
- Leaving the product outside exposed to weather, especially direct sun and rain, will speed the weathering process. This can be slowed by removing the product from these conditions, or covering it with a suitable cover.
- Keep fingers, loose clothing, and hair away when folding the product.
- This product is intended for outdoor use only.
- If the product is damaged or has any defects, please contact cservice@oypla.com

Parts List

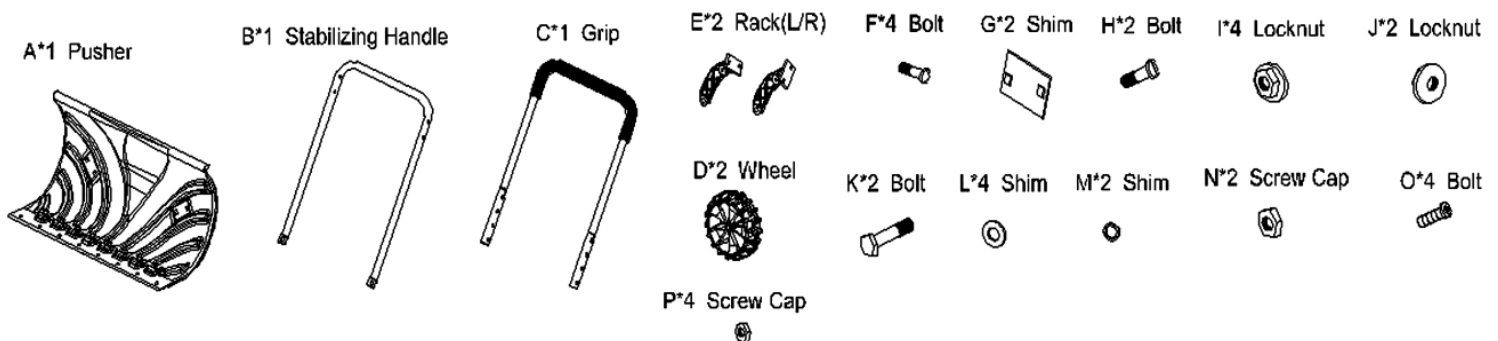

Operating Instructions

Step 1: Snow Shovel Head Assembly

Secure the snow shovel head onto the bracket. Insert 4pcs of (part F) from front of shovel through (part G) into (part E) and secure with (part I). As shown in below photo.

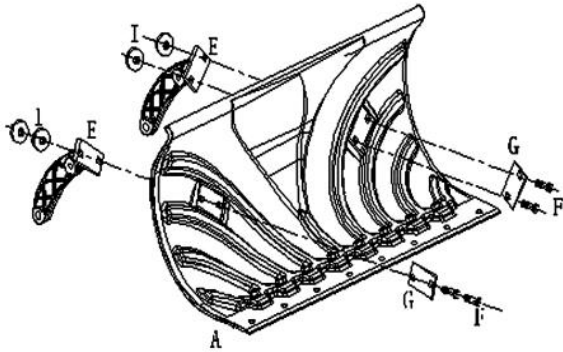

Step 2: Wheel Assembly

Using 2pcs of (part K), bolt the left and right wheels onto the brackets you assembled in Step 1. Use 2x (part L) for each to wheel to ensure it can turn freely and secure in place with (part N). As shown in below photo.

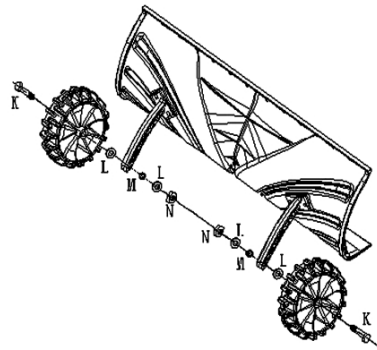

Step 3: Handle Assembly

Attach (part B) to the shovel frame using 2pcs of (part H). Attach (part C) to (part B) using 4x (part O) and (part P).

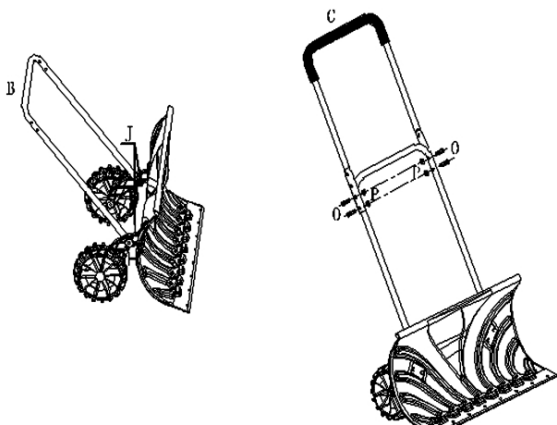

Step 4: Using Your Product

You should now have a fully assembled product. Please be careful while shovelling snow as your balance can be compromised. Only use this product as it was intended.

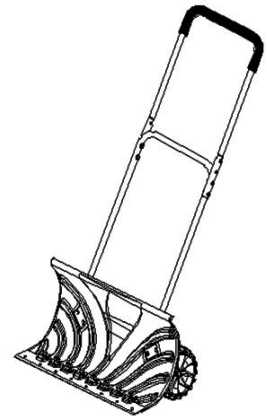

An Official Oypla Branded Product

Please retain a copy of all instructions for future consultation.